

Urinal Sensor UR018 with Circle IR

Easy Installation

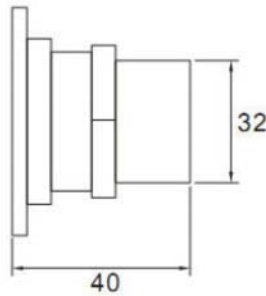
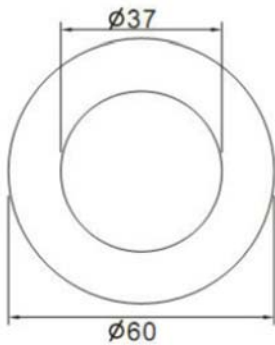

Plastic Valve Design
Suitable Use in Salt
Water

Technical Information

Optional power type :	AC 220V / Hydro Generator
Working pressure :	0.8bar~5bar
Water inlet / outlet :	G 1/2"OT
Water flow :	1.5-4L(10s flush time based on water pressure 3-6bar
Valve reacting time :	open≤0.5sec
Flow capability :	0.5bar≥5L/min, 3bar≥20L/min, 8bar≥60L/min
Valve working life :	more than 200,000cycles
Detection time (Factory Setting) :	7sec.
Default pre-flush Time :	3sec.
Flush time (Factory Setting) :	6sec.



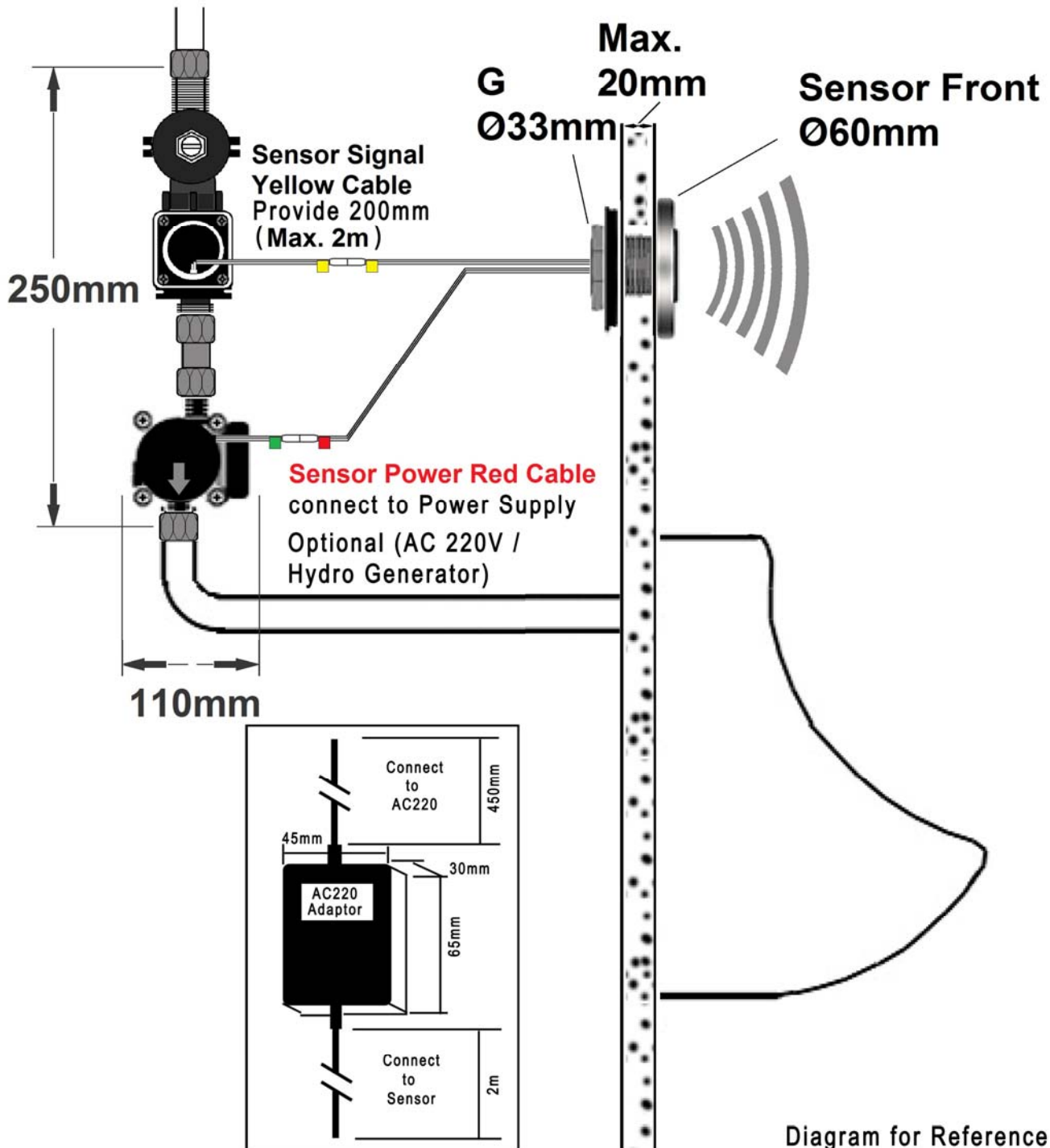



水務署
Water Supplies Department

香港灣仔告士打道七號入境事務大樓
Immigration Tower, 7 Gloucester Road, Hong Kong

電子郵件
e-mail wsdinfo@wsd.gov.hk

電話
Telephone 2829 4367

圖文傳真
Facsimile 2824 0578

檔號
Reference (4) in WSD 3321/13 Pt.1 T/J(277)

27 November 2013

K&E Technology Limited
Room A, 6/F., Sunrise Industrial Building,
10 Hong Man Street, Chai Wan,
Hong Kong

(Attn.: Mr Sunny CHUNG)

Dear Sir,

Approval of "K&E TECHNOLOGY" Flushing Valve

Your letters dated 1 November 2013 and 14 November 2013 refer.

Having considered test report ref. J17162 issued on 22 October 2013 by the Nutek Systems, Ltd., this Authority accepts that the fittings described below comply with, and their use when correctly installed does not contravene, the Waterworks Ordinance and Regulations.

Name of Manufacturer: Ningbo Zhanying Induction Equipment Co., Ltd

Country of Origin: China

Brand: K&E Technology

Details of Fitting: 1/2" Flush valve for urinal; AC and DC powered

Model: UR018

Proviso: As the fittings have not been tested for use in contact with water intended for human consumption, the fitting can only be used in flushing water plumbing system.

This Authority hereby permits the use of the above fittings in flushing water plumbing systems subject to full adherence to Waterworks installation requirements. In particular, you are required to draw your customers' attention to the following requirement-

“The design flushing volume of the flushing device should be compatible with the urinal to ensure that effective clearance can be achieved by a single flush of water.”

“The flushing volume of the flushing valves should be adjusted to suit the design of the toilet bowl so that wastes can be cleared effectively by a single flush.”

“Installation of filters before flushing valves is required. Without the filters, the flushing valves are liable to leak. The installed filters need frequent inspection and cleaning to maintain flushing supply. Normally only public toilets with good management system for maintenance would be considered.”

“As the water outlet of the fitting is immersed in water in actual use, no backflow of water will occur to contaminate the flushing water supply.”

“The fitting should be used within the range of working pressures specified by the manufacturer.” AND

“Installation of electronic opening and closing sanitary tapware should also comply with the requirements of Electrical & Mechanical Services Department.”

A condition of this acceptance is that the fittings to be installed shall be replicas of the samples as certified by the testing agent mentioned above and without modifications. This acceptance may be withdrawn at any time if the standard of the fittings installed fails to meet that of the approved samples or if the fittings are found to be unsuitable for use in flushing water plumbing systems.

For the use of the fittings in any project, the Acceptance Reference Number at the bottom of this letter must be quoted as a means of identification of acceptance of the fittings by this Authority.

Should you have any enquiries, please contact our Engineer Mr. Ken H
CHAN at tel. no. 2829 4453.

Yours faithfully,

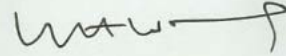

(WONG Kwok Hung)
for Water Authority